

ProPEX® Baseboard Elbow

Submittal Information
Revision B: April 13, 2011

Project Information

Job Name:	
Location:	Part No. Ordered:
Engineer:	Date Submitted:
Contractor:	Submitted By:
Manufacturer's Representative:	Approved By:

Technical Data

Material: 377 Brass

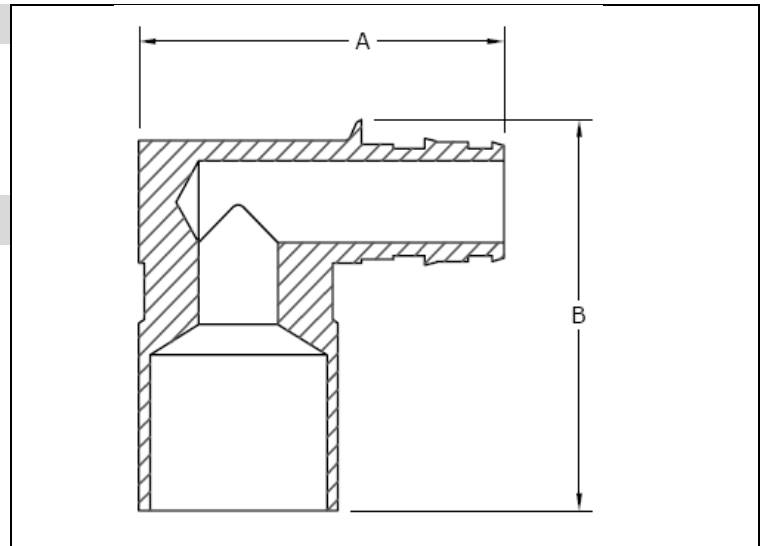

Product Information and Application Use

Uponor ProPEX® Baseboard Elbows are for use in any heating system applying the use of baseboard or unit-type heaters. One end of the adapter is manufactured with the Uponor ProPEX fitting to provide easy transition from copper pipe to Wirsbo hePEX™ or Uponor AquaPEX® tubing.

✓ Description	Part Number	A	B	Weight
ProPEX Baseboard Elbow, 1/2" PEX x 3/4" Copper Adapter	Q4385075	1.81"	1.90"	0.36 lbs.
ProPEX Baseboard Elbow, 5/8" PEX x 3/4" Copper Adapter	Q4386375	2.03"	1.94"	0.36 lbs.
ProPEX Baseboard Elbow, 3/4" PEX x 3/4" Copper Adapter	Q4387575	2.13"	2.00"	0.36 lbs.
ProPEX Baseboard Elbow, 1/2" PEX x 3/4" Copper Fitting Adapter	Q4375075	1.81"	1.90"	0.38 lbs.
ProPEX Baseboard Elbow, 5/8" PEX x 3/4" Copper Fitting Adapter	Q4376375	2.03"	1.94"	0.38 lbs.
ProPEX Baseboard Elbow, 3/4" PEX x 3/4" Copper Fitting Adapter	Q4377575	2.13"	2.00"	0.38 lbs.

Installation

Use the appropriate ProPEX Ring for tubing (sold separately). Do not solder within 18 inches of the ProPEX connection. Refer to the Uponor Radiant Floor Heating Installation Handbook for additional information.

Standards

ASTM F877; CSA B137.5; ASTM F1960

Codes

N/A

Listings

NSF-rfh

Related Applications

Radiant Heating and Cooling Systems
Snow and Ice Melting Systems
Permafrost Protection Systems
Turf Conditioning Systems

Contact Information

Uponor, Inc.
5925 148th Street West
Apple Valley, MN 55124 USA
Phone: (800) 321-4739
Fax: (952) 891-2008
www.uponor-usa.com

Uponor Ltd.
2000 Argentia Road, Plaza 1, Suite 200
Mississauga, ON L5N 1W1 CANADA
Phone: (888) 994-7726
Fax: (800) 638-9517
www.uponor.ca