

DIMENSIONAL SPECIFICATIONS

LEAD-FREE IMPORT BRASS FITTINGS* 125 LB.

90 DEGREE ELBOW

Part#	Size (IN.)	Approx. Net WT. (LB.)	A	B
XNL101-02	1/8	0.08	0.55	0.26
XNL101-04	1/4	0.10	0.72	0.35
XNL101-06	3/8	0.17	0.83	0.37
XNL101-08	1/2	0.24	1.03	0.45
XNL101-12	3/4	0.40	1.19	0.52
XNL101-16	1	0.64	1.43	0.60
XNL101-20	1-1/4	0.96	1.71	0.67
XNL101-24	1-1/2	1.16	1.87	0.70
XNL101-32	2	2.07	2.14	0.76
XNL101-40	2-1/2	3.83	2.74	0.93
XNL101-48	3	4.62	3.10	1.00
XNL101-64	4	7.70	3.80	1.10

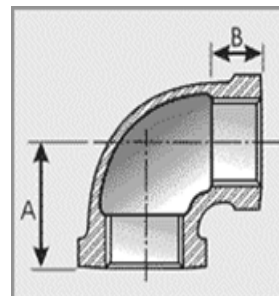

90 DEGREE STREET ELBOW

Part #	Size (IN.)	Approx. Net WT. (LB.)	A	B	C
XNL103-02	1/8	0.07	0.55	0.92	0.28
XNL103-04	1/4	0.11	0.72	1.11	0.32
XNL103-06	3/8	0.16	0.83	1.24	0.35
XNL103-08	1/2	0.24	1.03	1.51	0.45
XNL103-12	3/4	0.36	1.19	1.66	0.50
XNL103-16	1	0.62	1.43	1.98	0.58
XNL103-20	1-1/4	1.03	1.71	2.26	0.67
XNL103-24	1-1/2	1.27	1.87	2.46	0.75
XNL103-32	2	2.09	2.14	2.98	0.78
XNL103-40	2-1/2	4.05	2.74	3.92	0.92
XNL103-48	3	6.38	3.10	4.45	0.98
XNL103-64	4	11.44	3.80	5.63	1.08

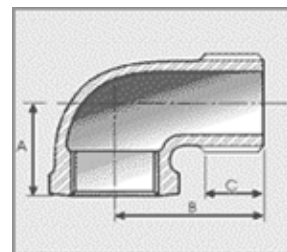

*Conforms with lead content requirements for lead-free plumbing as defined by the U.S. Safe Drinking Water Act. Certified <0.25 weighted average % lead.



MERIT BRASS

DIRECTING THE FLOW OF *Quality*