

LF 1/2" Straight Water Hammer Arrestor



Product Features

- For single fixture use
- Helps to eliminate shock waves generated in piping systems by sudden on/off changes in flow
- Polypropylene Piston
- AA arrestors are suitable for 1-3 fixture units
- May be installed at any angle.
- To function more effectively, please install within 6 feet of the fixture the arrestor is servicing.
- Approved for installation with no access panels required.



PFXWHASD

Product Specifications

Temperature Range: 33°F to 180°F
Max. Working Pressure: 350psi
ASSE 1010-2004
IAMPO Listed (cUPC)
Certified to NSF 372 requirements

Model Numbers	A	B
PFXWHASD	1/2" Copper Male Sweat	4-3/4" (120.6mm)

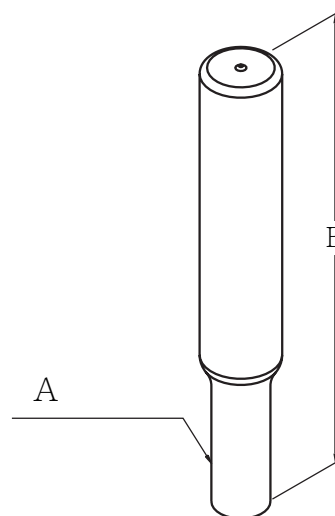

Warranty and Codes

This PROFLO product carries a 1-year limited warranty.

