

# LF 1/2" CPVC Water Hammer Arrestor



## Product Features

- For single fixture use
- Helps to eliminate shock waves generated in piping systems by sudden on/off changes in flow
- Polypropylene Pistone
- AA arrestors are suitable for 1-3 fixture units
- May be installed at any angle.
- To function more effectively, please install within 6 feet of the fixture the arrestor is servicing.
- Approved for installation with no access panels required.



PFXWHACFD

## Product Specifications

Temperature Range: 33°F to 180°F  
 Max. Working Pressure: 350psi  
 ASSE 1010-2004  
 IAMPO Listed (cUPC)  
 Certified to NSF 372 requirements

Model Numbers	A	B
PFXWHACFD	1/2" CPVC Female Socket	4-1/16" (103.1mm)
PFXWHACSD	1/2" CPVC Male Spigot	3-3/8" (80.5mm)

PFXWHACFD

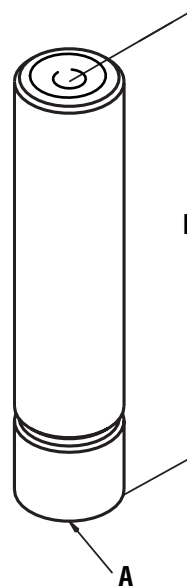

PFXWHACSD

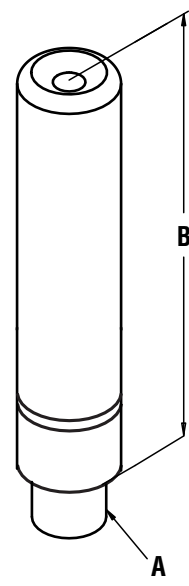

## Warranty and Codes

This PROFLO product carries a 1-year limited warranty.

