

Trusted. Tested. Tough.®

Product information presented here reflects conditions at time of publication. Consult factory regarding discrepancies or inconsistencies.

Patent No. D740329



SECTION: 2.65.070

FM2803

0520

Supersedes

0919

TECHNICAL DATA SHEET



Preassembled Sump Pump System with Battery Backup

PRODUCT SPECIFICATIONS

AC PUMP

- Model 73 (see FM2897), 53 (see FM2778) or 63 (See FM2899 or 98 (see FM2779)

DC PUMP

- Model 507 Basement Sentry® or Model 508 Aquanot®, 12 Volt DC backup system with pump, check valve, float switch and piping
- Plumbed in 1-1/2" Sch 40 PVC pipe

DC CHARGER / CONTROLLER

- Battery burnout and overcharge protection
- Solid state automatic controllers with alarms, light indicators and warning systems
- Active, Fit and Spin. Controllers monitor and supervise switch connections, and self test the pump
- Active and Fit controllers are Z Control® enabled with built-in WiFi. This allows for alert notifications and remote access.

LED LIGHT INDICATORS AND ALARMS

- System ready
- Battery charging / charged
- Battery fault condition
- Switch fault condition
- Pump cycled

FLOAT SWITCH

- Reliable and adjustable vertical master switch
- High water reed sensor (Included with Active and Fit models optional with Spin models 10-4830)

BATTERY CASE

- Polyethylene battery case
- Will accommodate maximum battery dimensions of 13" L x 7-1/2" W x 9-1/2" H (33 L x 19 W x 24 H cm)
- Accommodates all group size 27, 29 and 31 batteries

AQUANOT® BATTERY

Size 31 "Wet" P/N 10-0761 (69 lbs. [31 kg]) (shipped via truckline only) 200 minute reserve capacity

- Size 27 "AGM" P/N 10-1450 (66 lbs. [30 kg]) 175-minute reserve capacity

NOTE: Basin and battery not included
507 DC Pump requires 30° angle. 508 DC Pump does not.

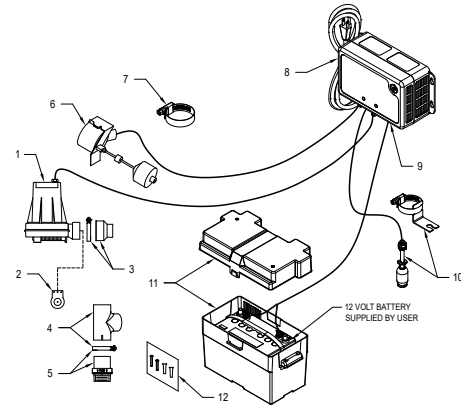

SK3183

Model 508

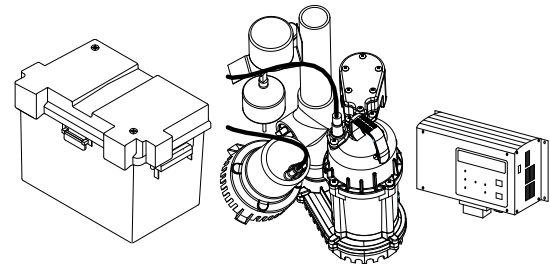

Model 507

SK3099

DC PUMP INSTALLED IN LINE WITH SUBMERSIBLE PUMP

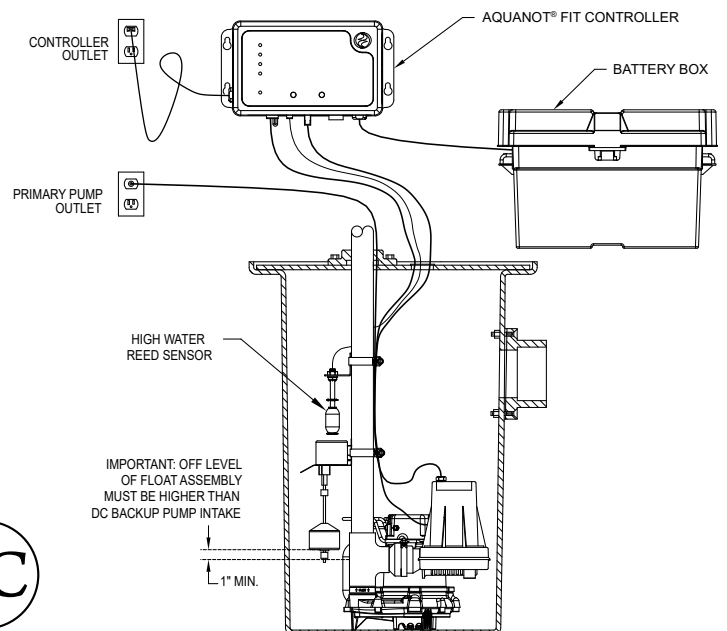

SK3182



© Copyright 2020 Zoeller® Co. All rights reserved.

502-778-2731 | 800-928-7867 | 3649 Cane Run Road | Louisville, KY 40211-1961 | zoellerpumps.com

TOTAL DYNAMIC HEAD FLOW PER MINUTE

DC PUMPS @ 12.7 volts

MODEL		507		508	
Feet	Meters	Gal	Liters	Gal	Liters
5	1.5	22	83	43	163
10	3.0	13	49	35	132
15	4.6	-	-	27	102
Shut-off Head		14-1/2 ft. (4.4 m)		22 ft. (6.7 m)	

NOTE: Above performance chart based upon actual performance achieved with a 12 Volt deep-cycle battery. Some manufacturers publish performance data based upon D.C. Pump testing according to Marine Industry standards which can reflect a performance of 40% - 80% higher than actual battery powered performance.

See FM2897 (Model 73), FM2778 (Model 53) or FM2779 (Model 98) for complete pump specifications.

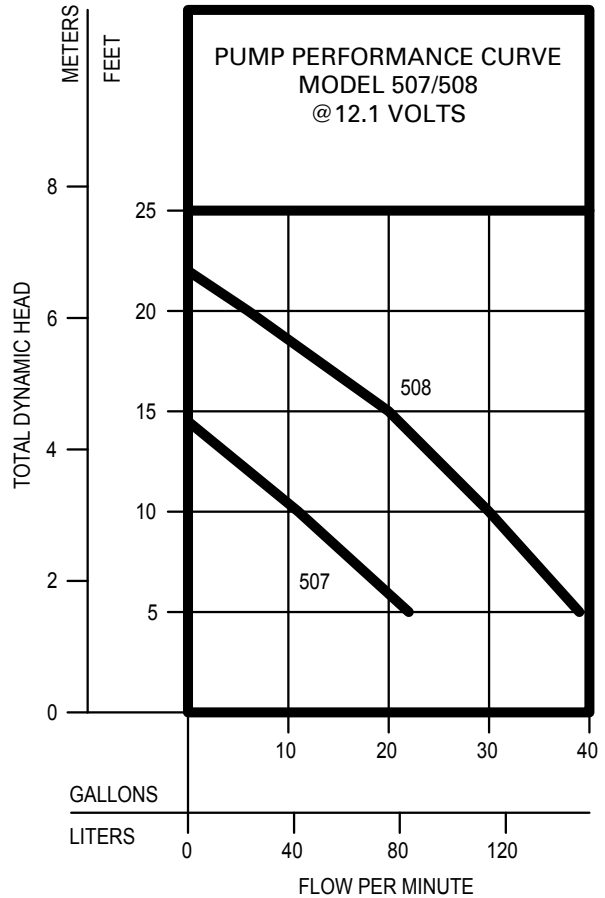

ProPak Item	Controller	73	53	98	63	Z Control®
507-0013	Basement Sentry I	X				
508-0006	Spin		X			
508-0007	Spin			X		
508-0015	Fit		X			X
508-0016	Fit			X		X
508-0020	Fit				X	X
508-0013	Active				X	X

AC PUMPS

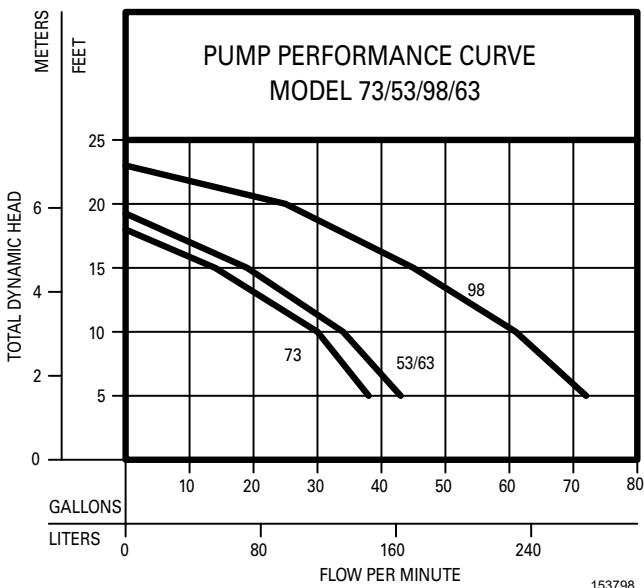

TOTAL DYNAMIC HEAD/FLOW PER MINUTE EFFLUENT AND DEWATERING

MODEL	73		53/63		98		
Feet	Meters	Gal.	Liters	Gal.	Liters	Gal.	Liters
5	1.5	38	144	43	163	72	273
10	3.0	30	114	34	129	61	231
15	4.6	14	53	19	72	45	170
20	7.1	--	--	--	--	25	95
Shut-off Head:		18 ft.(5.5 m)		19.25 ft.(5.9 m)		23 ft.(7.0 m)	



All installation of controls, protection devices and wiring should be done by a qualified licensed electrician. All electrical and safety codes should be followed including the most recent National Electrical Code (NEC) and the Occupational Safety and Health Act (OSHA).

© Copyright 2020 Zoeller® Co. All rights reserved.

502-778-2731 | 800-928-7867 | 3649 Cane Run Road | Louisville, KY 40211-1961 | zoellerpumps.com